



MADE IN USA  
With Global Materials



# SCKIT-75 SCKIT-5

## Mini Starter Kits

- Replaces many different capacitor sizes both singles and duals.
  - All units dual rated for 370/440 VAC.
- Simple to use.
  - Reduces truck stock.
- Finish the service job in just one trip. You always have the right size capacitor!
- Each pod can be used as a stand alone unit or stacked to get the MFD value needed.
  - Sigma Cap holds a US Patent. #10,199,755 B2
  - Made in the USA With Global Materials
- Saves time and trips to the parts house.
- Permanent fix. No reason to return to the job!
- Individual pods available so you can adjust stock for your most common builds.
- Rotate & stack the pods to add capacitance on the correct side to build the dual capacitor needed.
- Mini Starter Kits supplied in a reusable clear container.

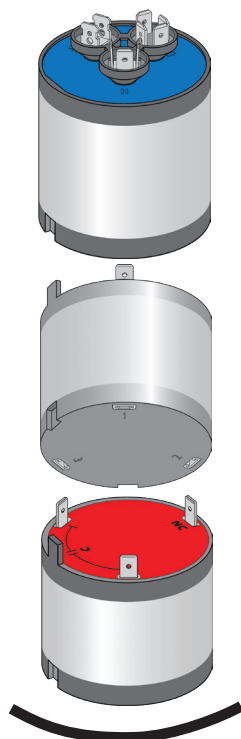

Add up the numbers down each side to confirm the MFD rating!

### ★ ADDITIONAL AVAILABLE PODS

Part No.	Value	Body Height	Term Height	Total Height	Dia.
SC3	2.5 $\mu$ F	1.938"	0.289"	2.227"	2.5"
SC15	15 $\mu$ F	2.1"	0.289"	2.389"	2.5"

Rotate and stack the pods to add capacitance on the correct side to build the dual capacitor needed

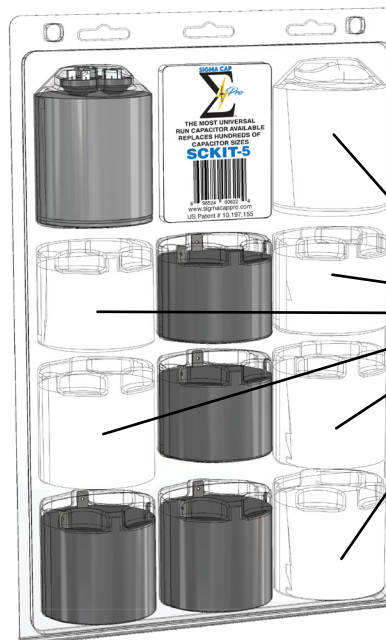

STORAGE FOR ADDITIONAL PODS! (SOLD INDIVIDUALLY)

## SCKIT-75

Part No.	Kit Qty	Value	Body Height	Term Height	Total Height	Dia.
SC2575	1	25/7.5 $\mu$ F	2.63"	0.531"	3.161"	2.5"
SC5	1	5 $\mu$ F	1.938"	0.289"	2.227"	2.5"
SC10	1	10 $\mu$ F	1.938"	0.289"	2.227"	2.5"
SC20	1	20 $\mu$ F	2.1"	0.289"	2.389"	2.5"
SC30	1	30 $\mu$ F	2.1"	0.289"	2.389"	2.5"
SCEC	2	ENDCAP				2.5"

## SCKIT-5

Part No.	Kit Qty	Value	Body Height	Term Height	Total Height	Dia.
SC255	1	25/5 $\mu$ F	2.63"	0.531"	3.161"	2.5"
SC5	1	5 $\mu$ F	1.938"	0.289"	2.227"	2.5"
SC10	1	10 $\mu$ F	1.938"	0.289"	2.227"	2.5"
SC20	1	20 $\mu$ F	2.1"	0.289"	2.389"	2.5"
SC30	1	30 $\mu$ F	2.1"	0.289"	2.389"	2.5"
SCEC	2	ENDCAP				2.5"

★ MASTER KIT AVAILABLE - PART NO. SCKIT

